

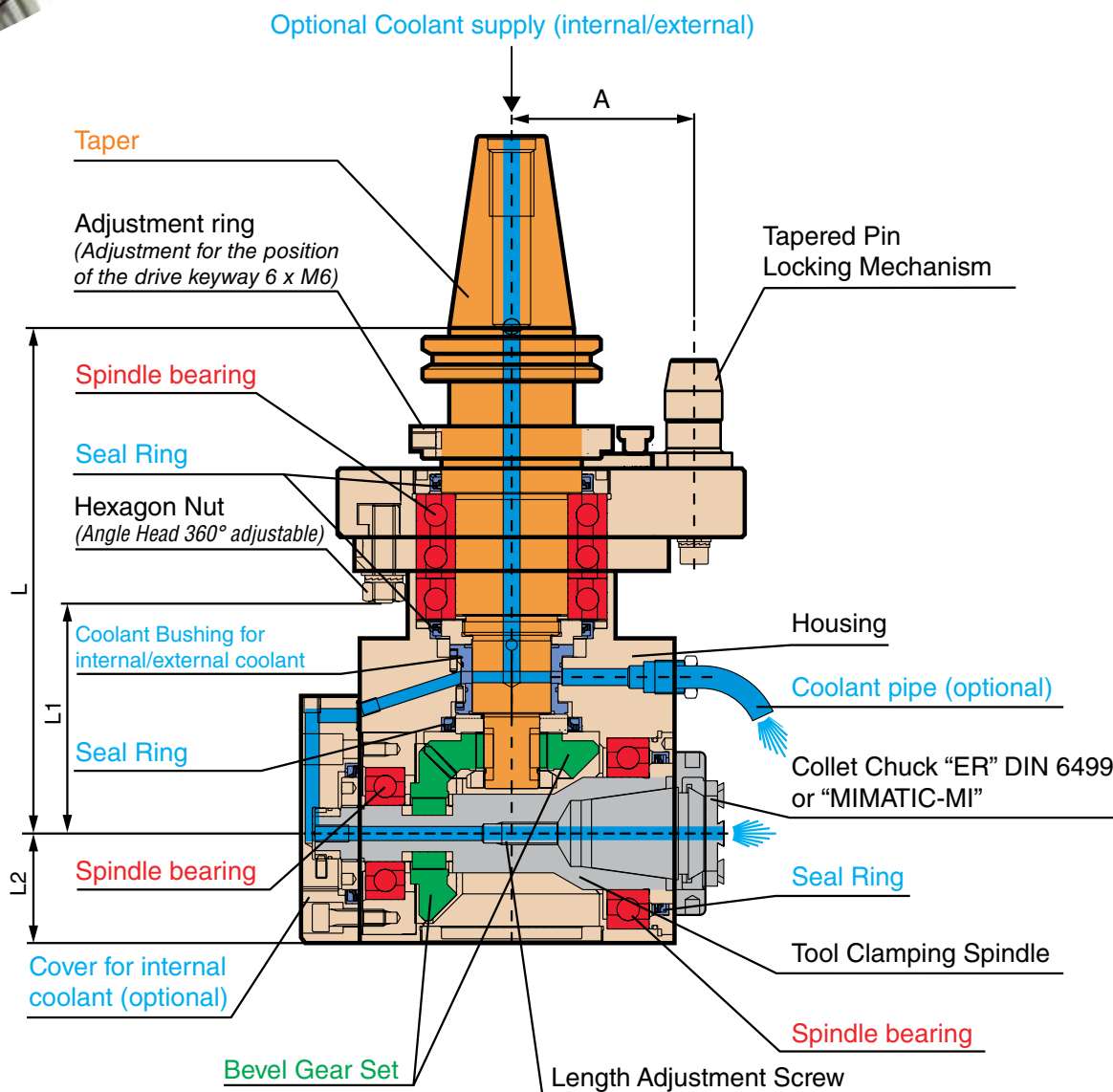

Technical Features



Our Angle Heads are equipped with hardened and ground gears and collet shafts. Units are also fitted with high-precision angular contact bearings, assuring extreme rigidity and accuracy. Compact designs maintain accurate spindle and tool centerline alignment while minimizing tool overhang - accuracy is maintained throughout the machining process from plane to plane.

Recessed Collet Seat



With our collet seat recessed into the body of the Angle Head, rigidity is optimized while maintaining a compact design.

High Precision Assembly



Our Angle Heads are assembled with high precision, P4 quality spindle bearings that are stabilized for high speeds up to 15,000 RPM and high torques up to 110 ft-lbs. The spiral beveled gears allow for high rigidity and smooth machining operations.

Types of Fixed Angle Heads



Nikken Right Angle Heads



Standard Right Angle Heads



Offset Type Right Angle Heads



Economy 40 Taper Right Angle Heads



Slim Type Right Angle Heads



Twin Spindle Angle Heads



Universal Flexheads - Internal Coolant



Quick Change Right Angle Heads
(Attachments sold separately)



Nikken Spindle Speeder
(up to 20,000 RPM)



All Angle Heads come with a tapered positioning pin as standard



A flat pin can be made available upon request

Modular Angle Head Assembly

Construct a Modular Angle Head in 3 Easy Steps!

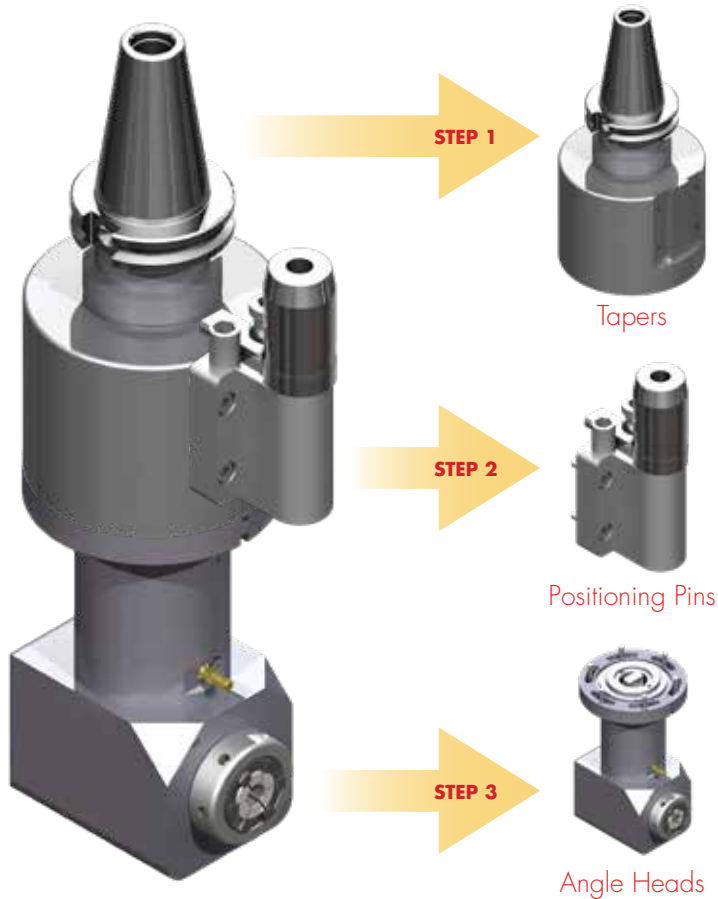

Modular Angle Head System Features

- Flexibility for a multitude of applications
- Adaptable with a wide variety of machine tapers
- Bolt style mounting system between taper and modular attachment for added rigidity
- Cost effective solution when Angle Heads are required on machines with different tapers
- 360 degree body and head rotation
- Tapered positioning pin for alignment accuracy

Modular Attachment Features

- Slim styles for inner bore work
- Stubby styles for added milling rigidity
- Extended Length styles for added reach
- Quick Change system for operations involving multiple tools
- Double output styles eliminate the necessity for two heads
- NSK output styles for small internal engraving and light duty drilling

Coolant Configurations

Coolant Supply Through The Spindle

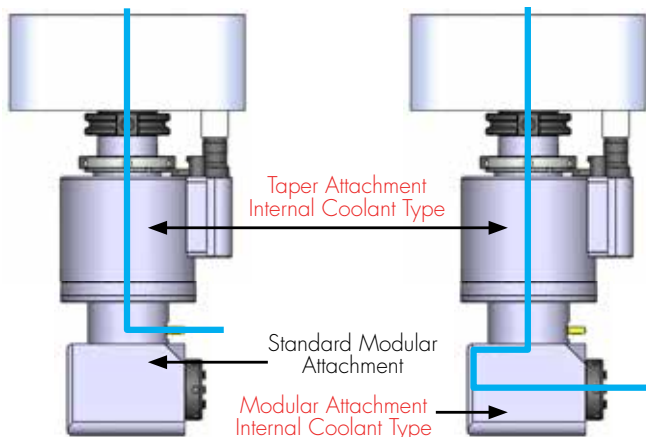

External Coolant

Internal Coolant

Coolant Supply Through The Positioning Block

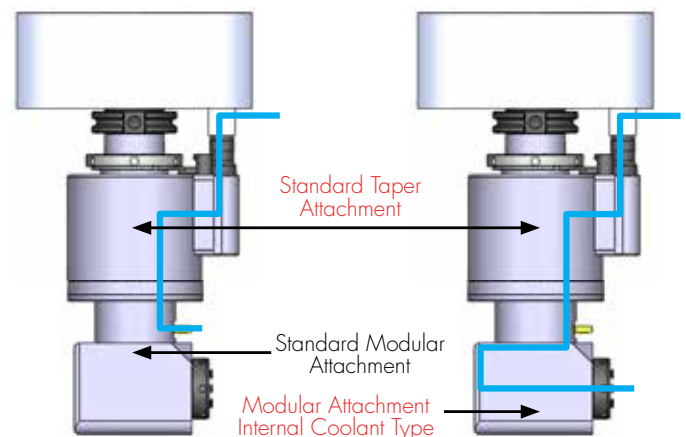

External Coolant

Internal Coolant

Modular Angle Head System

Flexibility for Any Application!

TAPERS



TAPER EXTENSION



MODULAR ATTACHMENTS



ER11 Adapter

ER11 Adapter Slim

ER11 Adapter Long

ER16 Adapter

ER16 Adapter Slim

ER16 Adapter Long

ER20 Adapter



ER20 Adapter Slim



ER20 Adapter Long



ER25 Adapter



ER25 Adapter Slim



ER25 Adapter Long



ER16 Double Output



ER25 Double Output



NSK Adapter



MI32 Quick Change



MI32 Quick Change Long



MI40 Quick Change



MI40 Long Quick Change

High Productivity Angle Heads

Fixed Angle Heads

Fixed Angle Heads ensures an accurate angle without the need to adjust or verify the cutting angle. Ideal for families of parts with a common fixed angle or for high production where optimized rigidity is required to reduce cycle times.

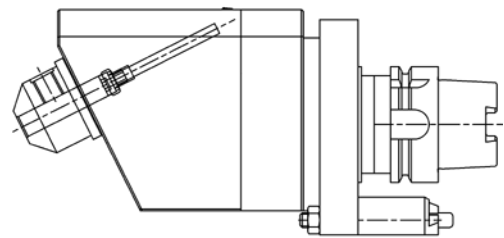
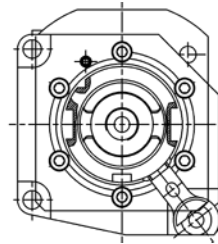

Multi-Spindle Drill Heads

Ideal for high production operations where drilling speed and accuracy must be optimized; Lyndex-Nikken Multi Spindle units can be designed for all materials, multiple drill sizes, and a varying number of output spindles to match your application.



Special Angle Heads

From Gear Hobbing, Deep Bore Milling, High Torque Shell Mill Angle Heads, to High Speed Spindle Multiplier Angle Heads, we have your applications covered. Contact us for more details!



Saw Blade/Arbor Milling Head
with additional support pins



Heavy Duty Offset Arbor Milling Head
for diesel engine blocks



ER32 1-meter Extended Length
Modular Tool with internal coolant



ER11 Extended Length Slim Line
Angle Head for ID pocket milling

Engineering Support

Complete Engineering Support from Start to Finish!



Selecting the best Angle Head

- Fill out our Angle Head Questionnaire.
- Provide dimensional and material information about your part via 3D model and/or CAD drawing.
- Additional information about the machine, current processes and cycle times are gathered.



Verification of Clearance and Application

- 3D models of Angle Heads are used to verify internal motion in space-critical locations.
- Applications are qualified by determining torque calculations of the machining operation, and is verified again that the Angle Head can sustain the desired process.



Automatic Tool Change & Weight Confirmation

- ATC and weight clearances are confirmed.
- 3D printed Angle Heads and positioning blocks are available to ensure 100% dimensional accuracy and guarantees clearance while reducing cost and risk to the customer.

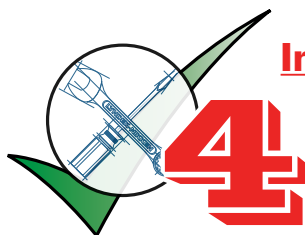

Installation & Additional Support

- Additional support for positioning block design and integration of the unit are also available.
- Positioning blocks are made to specifications, ensuring that the Angle Head is positioned and locked into place during final installation.



SPECIAL CUSTOM
POSITIONING BLOCK

Why risk your investment? We have you covered from design to installation!



Receive in-depth training on the cutting edge solutions of our products to help maximize your profits and increase productivity.

IN-DEPTH TRAINING AND LIVE DEMOS

SHRINK FIT



ADVANCED TOOLHOLDERS



POWER CHUCKS & QUICK CHANGE FLEX COLLETS



LIVE TOOLING



ANGLEHEADS

**To schedule a demo, contact your Lyndex-Nikken Regional Sales Manager
OR send an e-mail to: solutionselling@lyndexnikken.com**



Phone: (847) 367-4800



Email: sales@lyndexnikken.com



www.lyndexnikken.com

Connect with us on our
social media channels!

